

86 87 88 89

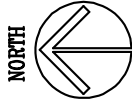
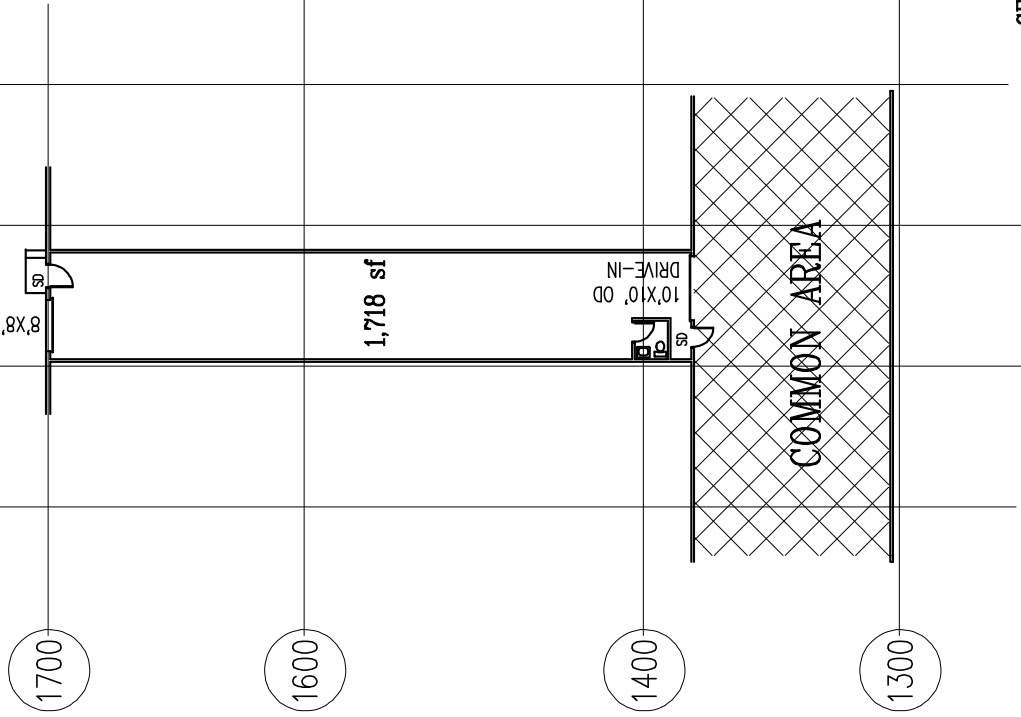

FLOOR AREA 1,718 sf
 CEILING HEIGHT 18'
 BAY SIZE 22'X40' & 22'X52'
 LOADING DOCKS ONE (DOCK HEIGHT 12")
 DRIVE-IN DOCKS ONE
 HEAT NATURAL GAS UNIT HEATER
 RESTROOM ONE
 SPRINKLER SYSTEM FULL DRY SYSTEM
 ELECTRICAL SERVICE 120/240V, 1P, 200A

INTERNATIONAL PARK
 COMMERCIAL & INDUSTRIAL BUSINESS CENTER

2701 SOUTH COLISEUM BLVD., FORT WAYNE, INDIANA 46803
 (260) 426-6680 FAX (260) 422-1329

ALL DOCK OVERHEAD DOORS ARE 8'X8' UNLESS NOTED OTHERWISE
 ALL SERVICE DOORS ARE 3' WIDE.

OD: OVERHEAD DOOR SD: SERVICE DOOR

FLOOR AREA

1,718 sf

LOCATION ID.

1292 BUILDING #27